

# SPECIFICATIONS FOR HANGKE **HIGH POWER GREEN LED**

## 杭科大功率绿色LED产品规格书



Model: HKP-PD0G5BN1 (D0G1)  
PD1G5BN1 (D1G1)

HangZhou HangKe Optoelectronics Co.,LTD.

[Http://www.hkled.com](http://www.hkled.com) 杭科光电



## 1. SPECIFICATIONS

### (1) Absolute Maximum Ratings

(Ta=25°C)

Item	Symbol	Absolute Maximum Rating	Unit
Forward Current	I <sub>F</sub>	350	mA
Pulse Forward Current	I <sub>FP</sub>	800	mA
Power Dissipation	P <sub>D</sub>	1.2	W
Junction Temperature	T <sub>j</sub>	120	°C
Operating Temperature	T <sub>opr</sub>	-30 ~ + 85	°C
Storage Temperature	T <sub>stg</sub>	-40 ~ +100	°C
Soldering Temperature	T <sub>sl</sub>	265°C for 5sec.	

IFP Conditions : Pulse Width 10msec. and Duty 0.1

### (2) Initial Electrical/Optical Characteristics

(Ta=25°C)

Item	Symbol	Condition	Min.	Typ.	Max.	Unit
Forward Voltage	V <sub>F</sub>	I <sub>F</sub> =350mA	—	3.2	—	V
Luminous Flux	φ <sub>v</sub>	I <sub>F</sub> =350mA	—	65	—	lm
Viewing Angle	2θ <sub>1/2</sub>	I <sub>F</sub> =350mA	—	120	—	Deg.
Dominant Wavelength	λ <sub>D</sub>	I <sub>F</sub> =350mA	520	—	530	nm
Thermal Resistance Junction To Solder Point	R <sub>th</sub>	—	—	5	—	°C/W
LED Junction Temperature	T <sub>j</sub>	—	—	—	130	°C



◆ Color Rank (Green)

M	x	0.173	0.193	0.212	0.176	0.142	0.116
	y	0.653	0.662	0.672	0.770	0.782	0.767

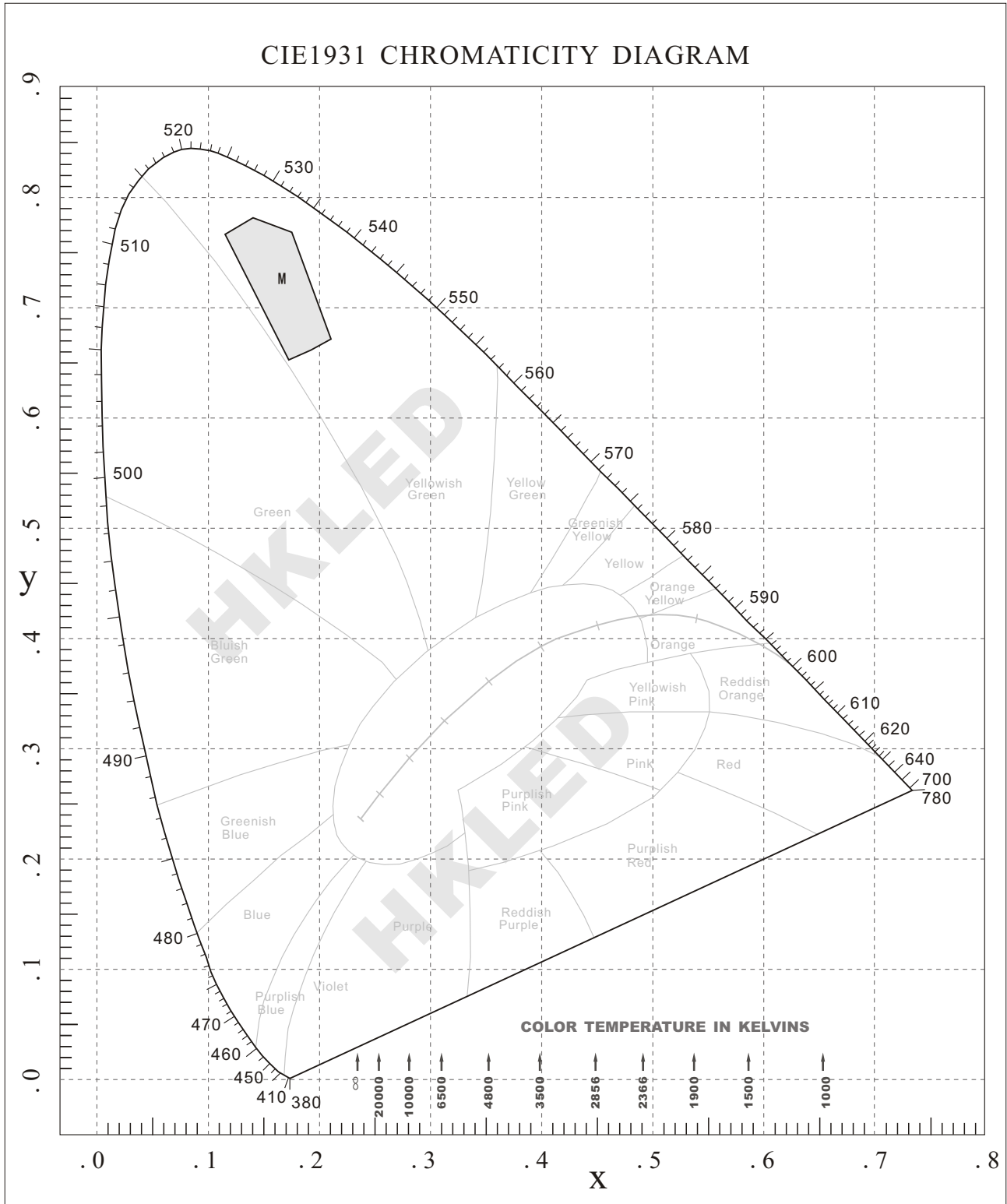

Color Coordinates Measurement allowance is ± 0.01



## 2.TYPICAL INITIAL OPTICAL/ELECTRICAL CHARACTERISTICS

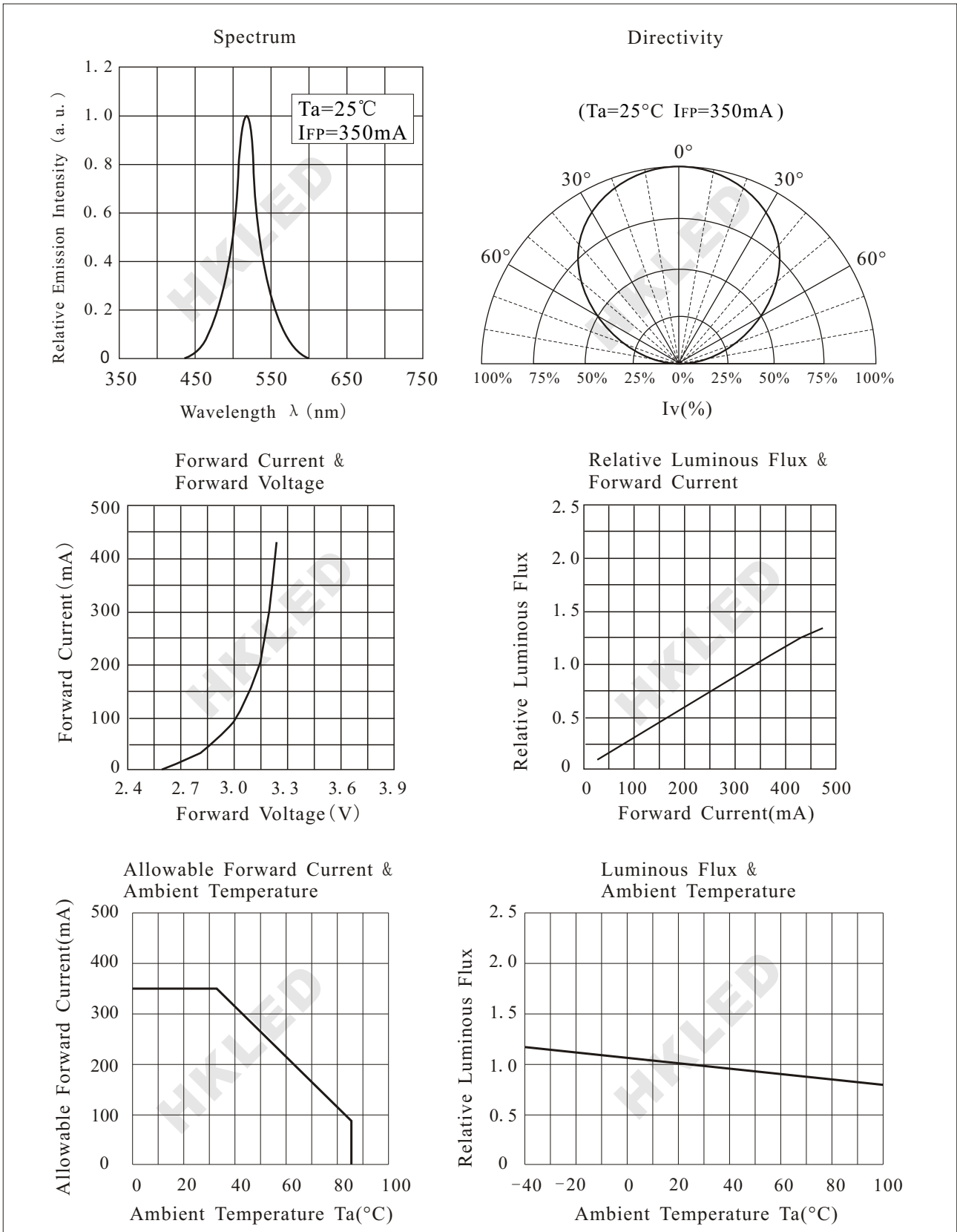



### 3. OUTLINE DIMENSIONS AND MATERIALS

#### Package Dimensions

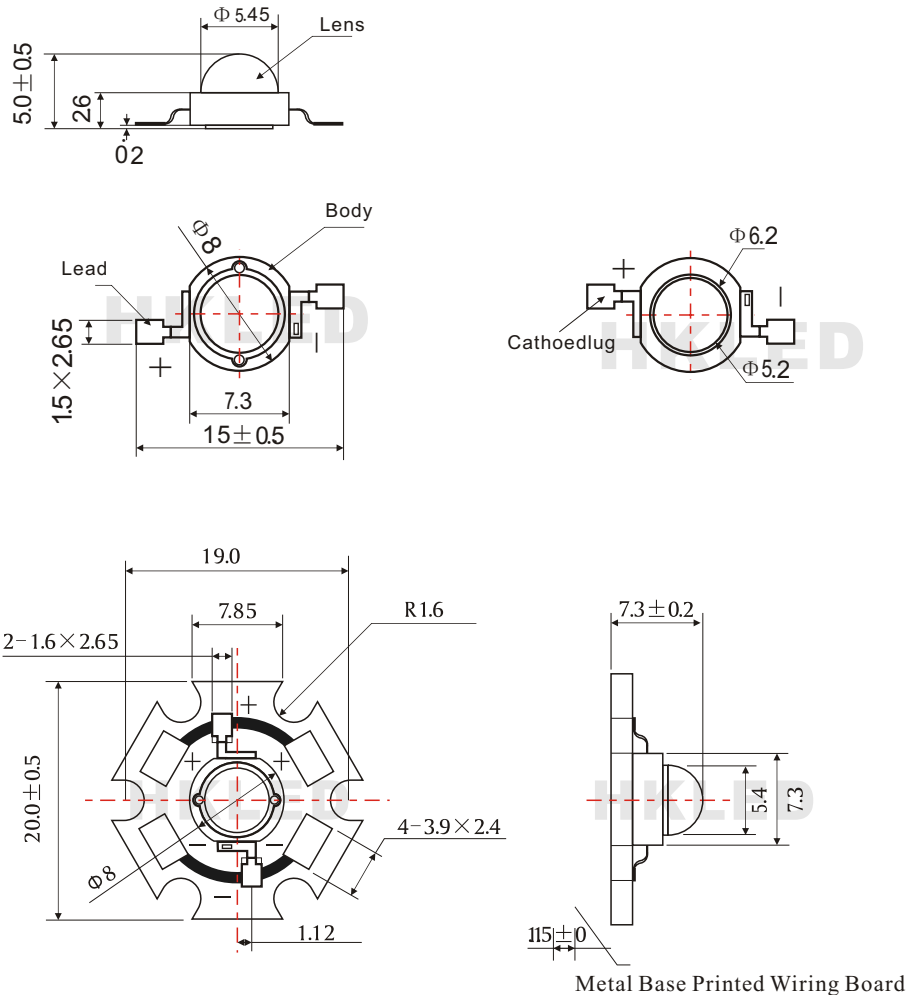

#### Notes:

1. All dimensions are in millimeters.
2. Tolerance is  $\pm 0.15\text{mm}$  unless otherwise noted.
3. Specifications are subject to change without notice.

- ◆ Lens Color : Water Clear
- ◆ Emitting Color : Highest Flux GREEN
- ◆ Chip material : InGaN
- ◆ Package : Heat-Resistant Polymer
- ◆ Lens : Silicone Resin
- ◆ Encapsulating Resin : Silicone Resin
- ◆ Electrodes : Ag plating Copper Alloy
- ◆ Metal Base : Aluminum